

STYROTM**RAIL**

expanded polystyrene insulation



product catalogue

A unique solution for your insulation needs

Insulating products
for all construction needs

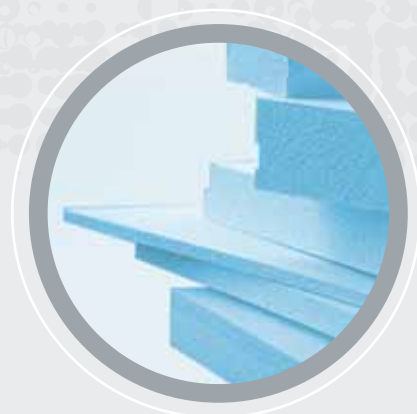

SECTION 07

01

STYRO RAIL™
The Company

07

SR.P™ 100-200
Roof insulating panels

06

SR.S™ 200
High performance
structural insulating panels

05

SR.F™ 200
Insulating panels for concrete formwork

09

SR.P™ 100-200-300
Insulating panels

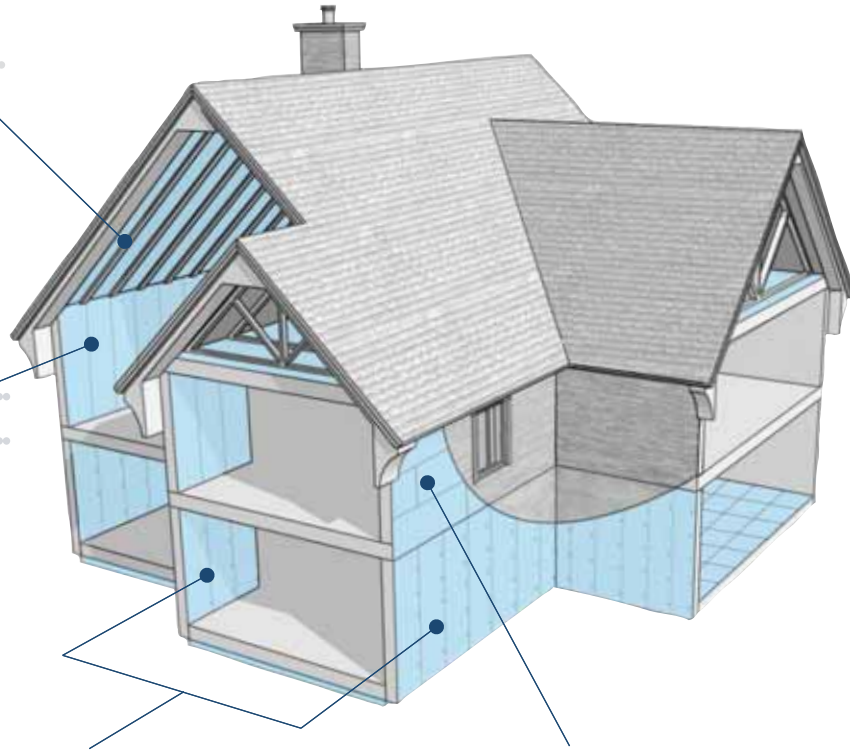

11

Other products

- SR.I Insulating panel with integrated wood furrings
- Filling blocks
- Floats for docks
- Architectural elements
- Packaging
- Expanded polystyrene beads
- Special cuts

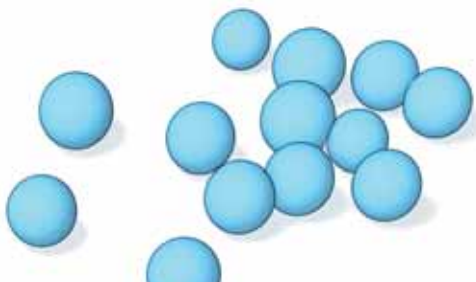

Styro Rail Inc.

Styro Rail inc. is an E.P.S. manufacturer specializing in insulation for residential, commercial, industrial and agricultural construction.

Since its creation in 1997, Styro Rail has worked with construction professionals and succeeded in improving their work practices, due to a clever and effective system of insulating panels for concrete formwork. The expanded polystyrene SR.F™ 200 are inserted in the formwork before the concrete as an alternative to traditional insulation. They provide incomparable thermal protection for a dry and comfortable space. This new product was awarded the prize of excellence Habitas-Innovation 2000 at the Montreal Home & Trends Show in 2000.

We offer a wide range of building products. Aside from the innovative SR.F™ 200, we also have products for the shipping and handling industry such as floating decks and packaging insulation. Styro Rail insulation products improve indoor air quality, increase sound-proofing and improve the energy efficiency of any building, thereby reducing heating and cooling costs. Manufactured in Canada, they can be used inside and out, are available in several densities, are chemically stable, and do not emit ozone-depleting substances. They provide high thermal protection and retain their insulating properties for life.

Our goal is to help our customers build a healthy, economical and energy efficient living environment. Styro Rail commits to providing you with quality insulating products which meet your comfort expectations!



Finest high-technology industrial plant.



Optimal environment for the production of insulation products.





SR.F™ 200

Expanded polystyrene insulating panel for concrete formwork

Use

SR.F™ 200 concrete formwork insulating panels are used as foundation insulation in new buildings. SR.F™ 200 is also used as concrete wall insulation.

Advantages

- + Mildew control – no air space between the concrete and insulation where warm moist air could infiltrate, condense and grow mould.
- + Odour control – is not conducive to bacterial growth.
- + Dry and comfortable space – no inside condensation.
- + Improvement of the air quality – no harmful gas emissions.
- + Higher energy efficiency – energy saving up to 1/3 of the costs of heating and air-conditioning. *
- + Versatility – inside or outside installation.
- + Compatibility – adapts to all types of traditional formwork.
- + Strength – composed of solid and anchored plastic ties through the concrete and provides solid substrate to anchor finishing.
- + Quickness – combines casting of concrete and insulating into a single step.
- + Stability – no ozone layer depleting emissions.
- + Durability – preserves its insulating properties for life.

** Compared to the traditional insulation method comprised of a vapour barrier, 2"x3" furings and batts of insulation.*

Dimensions

SR.F™ 200 insulating panels are 3" or 4" thick and are available in varying heights of 5'-6" to 10'-0" and widths from 2" to 24" for a perfect match with any form.

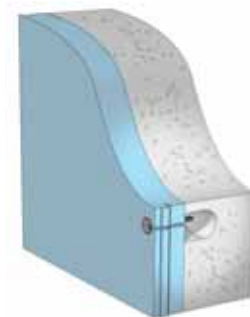

SR.F™ 200 3" = R13.79
 SR.F™ 200 4" = R17.79

R13.79

PATENTED PRODUCT

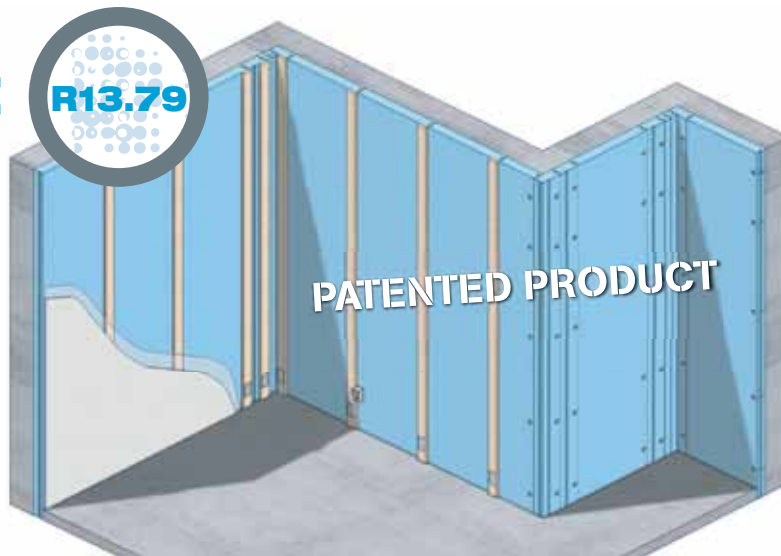

SR.S™ 200 structure

High performance structural insulating panels

Use

SR.S™ 200 structural insulating panels are used as an insulation system for the framework walls of new construction.

Advantages

- + Eliminate air leaks – the entire wall structure is wrapped in a continuous envelope from the outside, preventing the heat loss of wood framing.
- + Higher performance – 40% more effective than the traditional insulation method. *
- + Dry and comfortable space – no inside condensation.
- + Improvement of air quality – no harmful gas emissions.
- + Fast installation – combines framing and insulation into a single step.
- + Stability – no ozone layer depleting emissions. (No CFCs, HCFCs or coolant gas.)
- + Durability – retain their insulating properties for life.

** Compared to the traditional insulation method comprising of a vapour barrier, 2"x3" furrings and batt insulation.*

Dimensions

SR.S™ 200 structural insulating panels are available in widths of 4' to 8' and heights of 8' to 10'. The structure consists of wood components of 2" x 6" or 2" x 4" depending on the requirements.



SR.P™ 100-200

Roof insulating panels

Description

Roof insulating panels are made of rigid and closed plastic cells which ensure an optimal thermal performance and excellent water resistance.

Styro Rail offers the SR.P™ 100 (type 1) and SR.P™ 200 (type 2) as roof insulating panels. These different densities satisfy the varying requirements of builders, engineers and architects.

Use

SR.P™ insulating panels are used in new buildings and in renovations of cathedral roofs, low-slope roofs or steep-slope roofs.

Dimensions

SR.P™ 100 and SR.P™ 200 insulating panels are available in 4' x 8' and thicknesses to suit requirements and specifications. They can be ordered with a regular cut, an angled cut, or with capped joints on 2 or 4 sides.

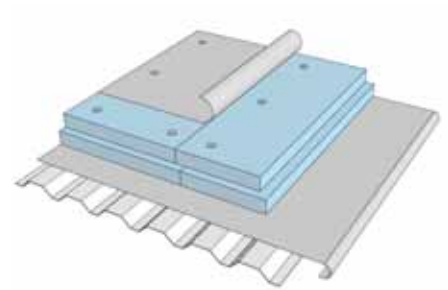

Low slope roof tongue-and-groove insulating panels.

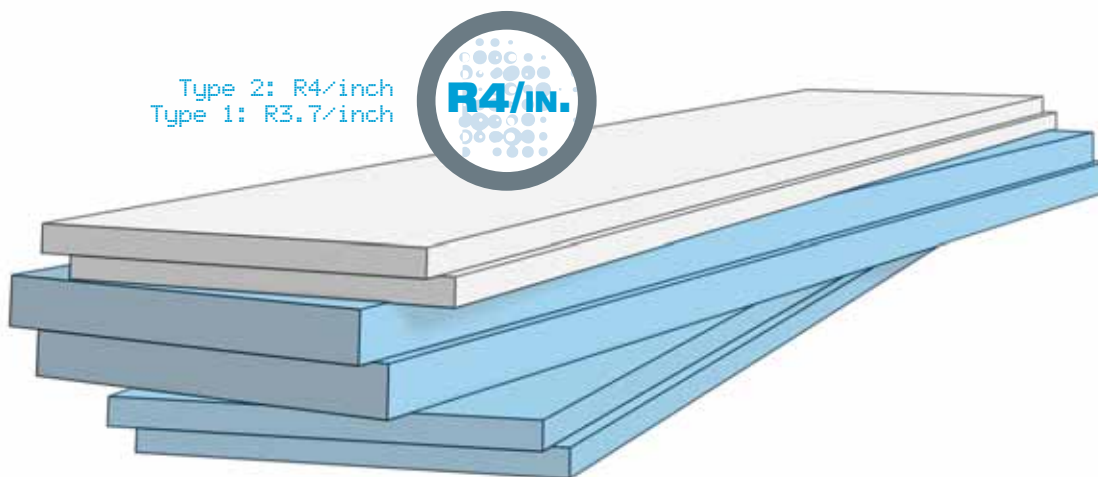

Type 2: R4/inch
Type 1: R3.7/inch

R4/in.

SR.IT™ 200

Post and beam home products

Description

Products for post and beam construction are custom-built. They vary in height and width and are assembled of insulation and plywood or insulation, plywood and gypsum board. The cut of the insulation, the assembly details, the insertions for electrical wire and plumbing pipes are designed based on the customer's needs.

Use

Post and beam building products are available to contractors looking for pre-machined nonstructural insulating panels to fill the space between the posts and beams of the building.

Dimensions

Built as per customer's specifications and dimensions.

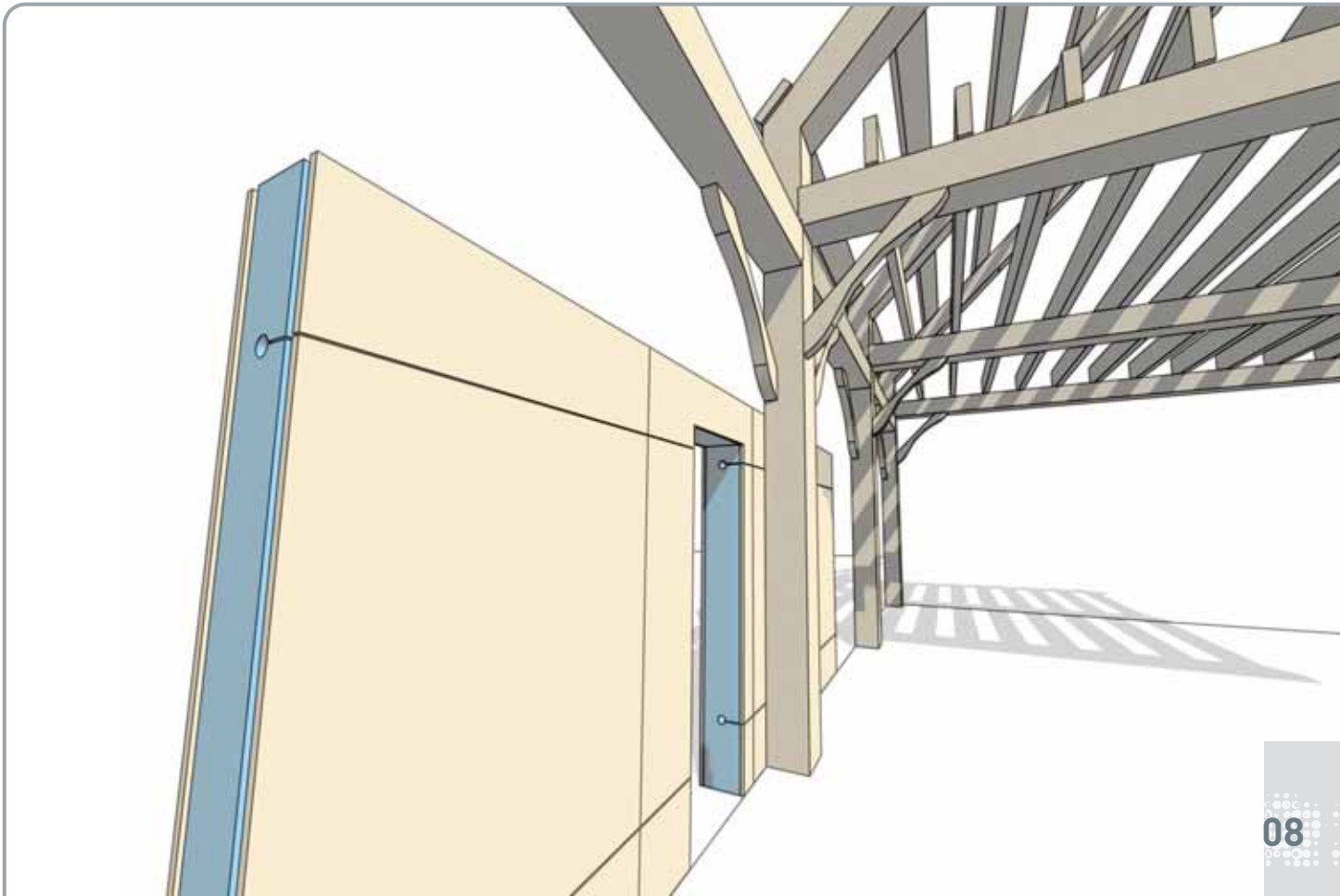

SR.P™ 100 - 200

Bulk insulation panels - type 1 and 2

Description

SR.P™ 100-200 insulating panels are made of rigid and closed plastic cells which ensure optimal thermal performance and excellent water resistance.

Use

SR.P™ 100-200 insulating panels can be used above-ground and below-ground, both indoor and outdoor. They can be used to insulate outside the foundation below ground, outside the walls above ground, the roof, and as a base for acrylic resin coating.

Dimensions

SR.P™ 100-200 insulating panels are available in the following dimensions in various thicknesses according to the customer's requirements.

2'x8'	•••	4'x8'
2'x9'	•••	4'x9'



Use of insulating panels below ground.

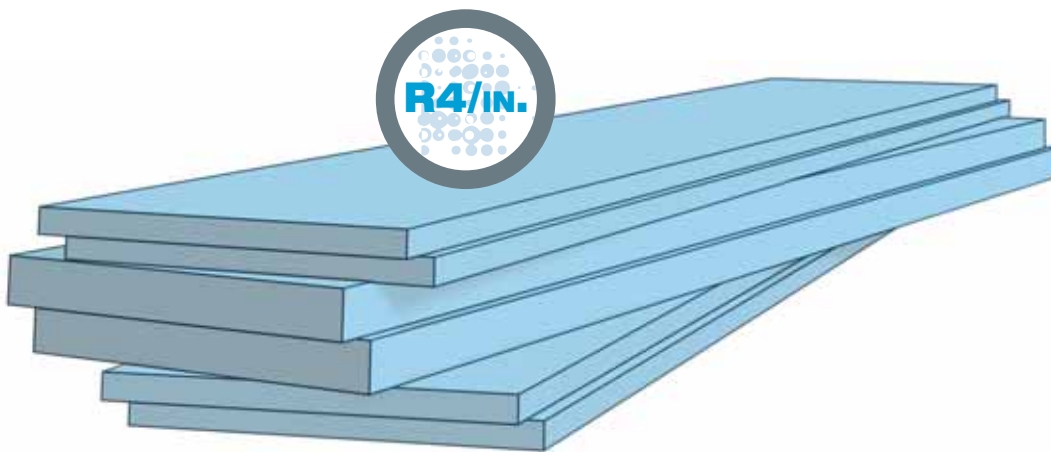

SR.P™ 300

Bulk insulation panels - type 3

Description

SR.P™ 300 insulating panels are made of rigid and closed plastic cells which ensure an optimal thermal performance and an excellent water resistance.

Use

SR.P™ 300 insulating panels are used when higher density insulation is required, for example under the concrete slab floor of a warehouse or as part of the underfilling of a road which requires insulation of greater compressive strength. They can be used indoors and outdoors, and for above or below ground applications.

Dimensions

SR.P™ 300 insulating panels are available in the following dimensions in various thicknesses according to the requirements of the builder, engineer or architect.

2'x8'	•••	4'x8'
2'x9'	•••	4'x9'

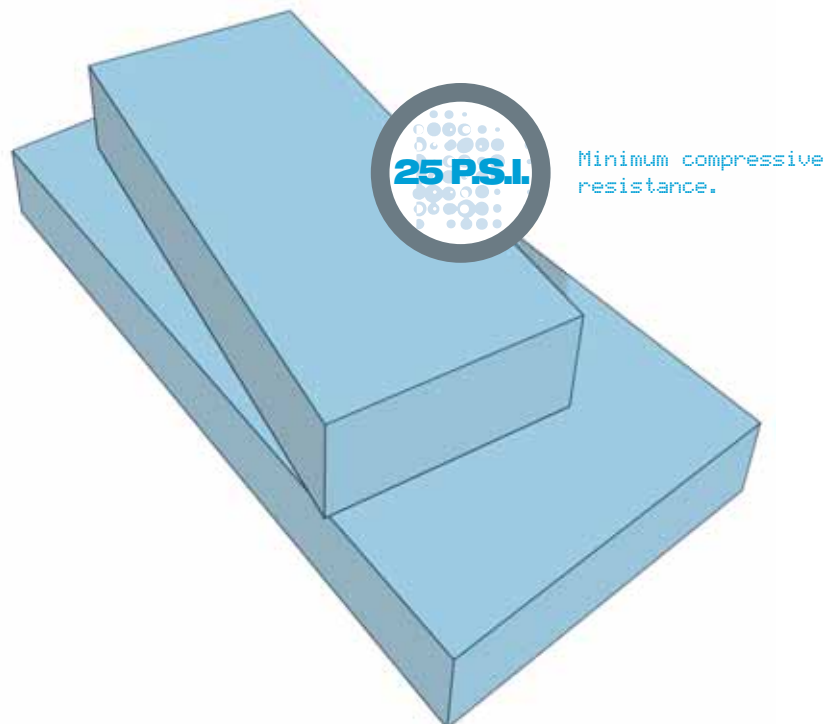

Other products

SR.I Insulating panel with integrated wood furrings

Use

Insulating panels with integrated wood furrings are used to insulate walls and garage ceilings. For new construction or renovations these panels will make insulation and gypsum board installation easy. In fact, the wood furrings are placed every 16" providing a surface for screwing and allowing for quicker installation.

Dimensions

The panels are available in widths of 2" to 6" and in the following sizes: 4'x8', 4'x9', 4'x10'.

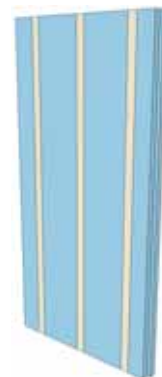

Filling blocks

Use

Filling blocks are used as thermal barrier under buildings, roads, railways, retaining walls, and underground parking garages in order to reduce the effects of freezing, to prevent road deterioration and to prevent the collapse of unstable grounds.

Dimensions

Custom built.

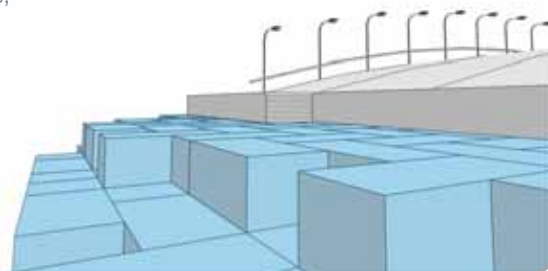

Floats for docks

Use

Expanded polystyrene floats are used to support a wooden dock.

Dimensions

Custom built.

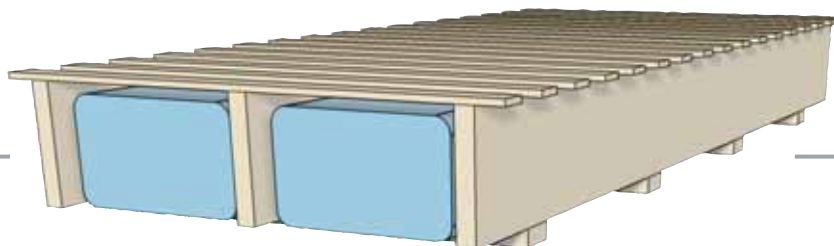

Architectural elements

Description

Styro Rail offers a range of expanded polystyrene decorative mouldings and columns which can be coated with acrylic. Create your own design! Our production team will work with you to execute your design.

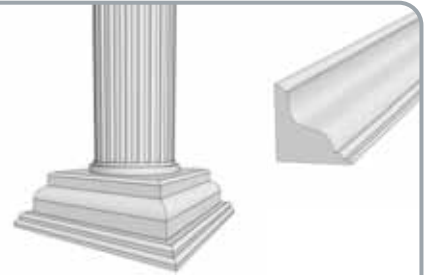

Packaging

Description

Styro Rail can create simple packing forms for the shipping and handling of fragile products.

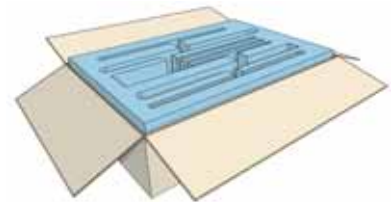

Expanded polystyrene beads

Description

For special projects or the filling of rigid shells, expanded polystyrene pearls can be used in bulk.



Special cuts

Description

Styro Rail offers custom cuts for special projects or for the replacement of expanded polystyrene parts:

- replacement of floats on certain models of canoes or boats;
- replacement of the expanded polystyrene protection shell of a spa;
- creation of giant letters for display panels;
- custom plumbing pipe insulation.



Aim for a healthy comfort!



Styro Rail insulation is made of rigid and closed plastic cells which ensure optimal thermal performance and which are water resistant. They do not emit any ozone layer depleting gases and respect all environmental standards. Easy to transport and to handle, Styro Rail insulation is inert, stable, and does not represent any food value thus will not attract animals, insects, parasites or plants.



Recycling

EPS can be recycled! Industry waste can be reused directly in the production. Post-production waste can also be recycled, up to 40% of recycled product for 60% of virgin raw material. Although it is easy to recycle EPS during production, the recycling of general consumer products made of EPS is not as easy. EPS is included in the plastic category No 6. Unfortunately, few cities and municipalities have the necessary installations to recycle No 6 plastic (foam coffee cups, plastic plates, appliance foam packing, etc).



EPS gives you more!

Styro Rail rigid foam is used to insulate foundations and slabs. It can also be applied on roofs, exterior walls and floors cavities, and may replace loose-fill or batt insulation.

EPS stands out from the gamut of rigid insulation offered on the market by its ratio of R factor to price. This reason makes it popular with the Canadian construction industry.



Styro Rail Inc.

T 819.643.4456

F 819.643.9403

1 888.332.3456



A unique solution for your insulation needs

As an expanded polystyrene manufacturer and a producer of concrete formwork insulation as well as wall systems, Styro Rail Inc. can provide you with a wide range of quality products to satisfy all your insulation needs.

Aim for Bluefox comfort!



www.styrorail.ca

Styro Rail Inc. / 1704 Arthur Fecteau, Gatineau, Québec, J8R 3T4



Proud canadian
producer

Copyrights 2006 Styro Rail Inc. All rights reserved. Printed in Canada.